

SERIES 2A

ELECTRICAL FUNCTIONS

SPDT			
1	on	none	on
2	on	none	(on)
3	on	off	on
4	(on)	off	(on)
5 (∅)	on	off	(on)
2 - 3	open		2 - 1

2 Comm.
1 ∅ 3 •

(∅) Please enquire

DPDT			
1	on	none	on
2	on	none	(on)
3	on	off	on
4	(on)	off	(on)
5	on	off	(on)
2-3, 5-6	open		2-1, 5-4

2 Comm. 5 Comm.
1 ∅ 3 • 4 ∅ 6 •

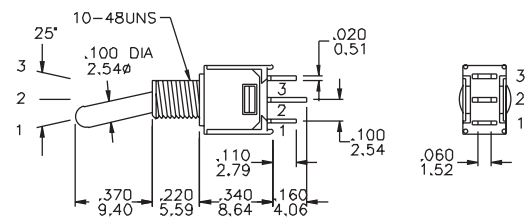
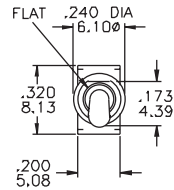

Part N° shown: 2A11-NF1STSE

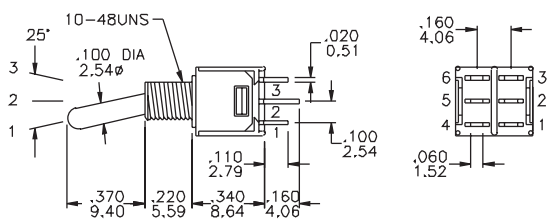
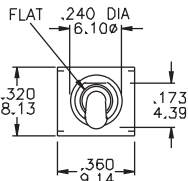

Part N° shown: 2A21-NF1STSE

ACTUATORS

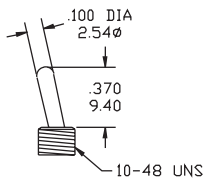

N

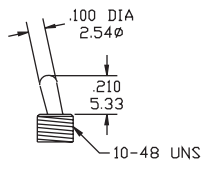

N2

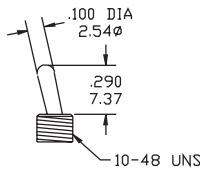

N3

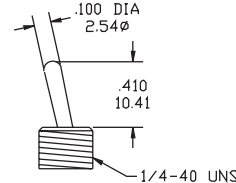

N4 (Δ)

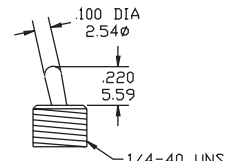

N5 (Δ)

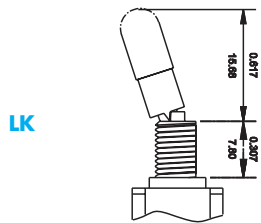

LK

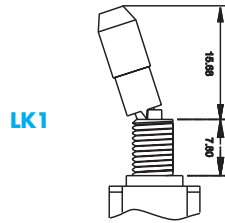

LK1

BUSHING

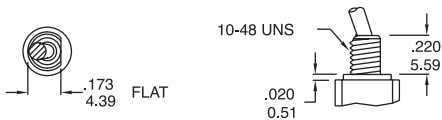

F1 Threaded
F2 Non Threaded

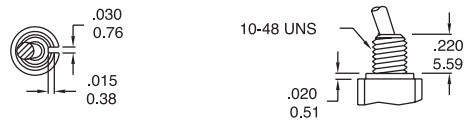

F3 Threaded
F4 Non Threaded

Note: F Bushings can fit actuators N, N2 and N3 only.

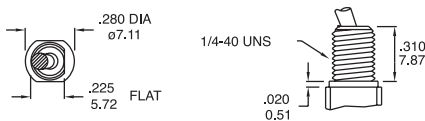

B1 (Δ) Threaded flat
B2 (Δ) Non Threaded flat

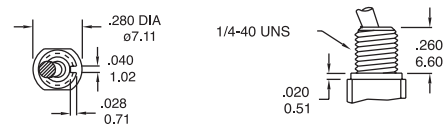

B3 (Δ) Threaded
B4 (Δ) Non Threaded

(Δ) Min qty required.

Note: B Bushings can fit actuators N4 and N5 only.



SERIES 2A

TERMINATIONS

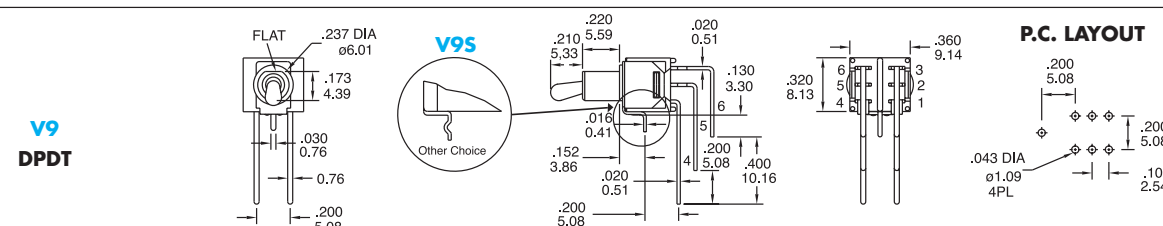
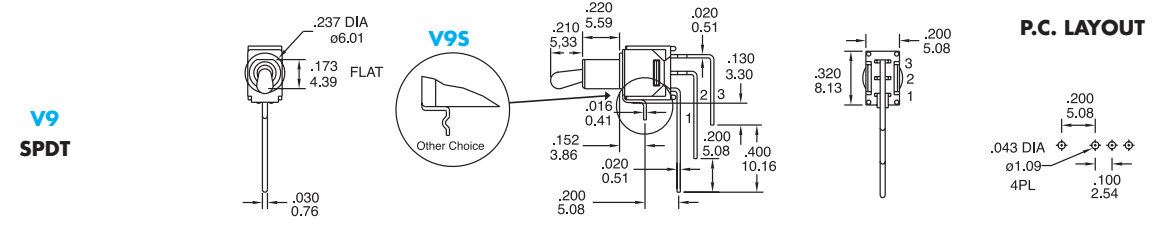
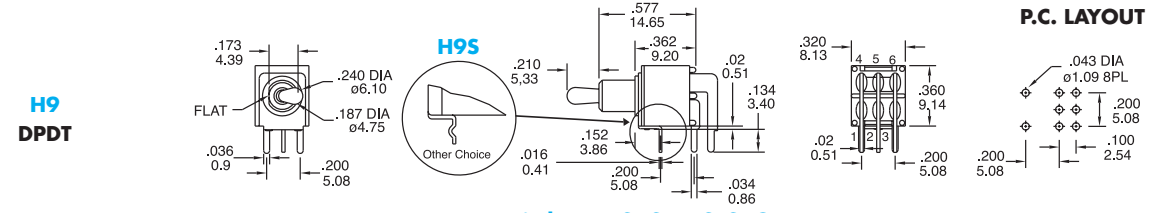
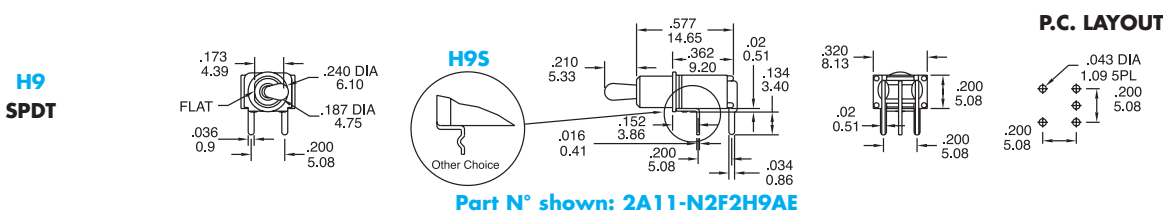
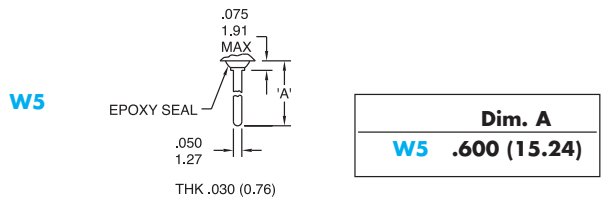
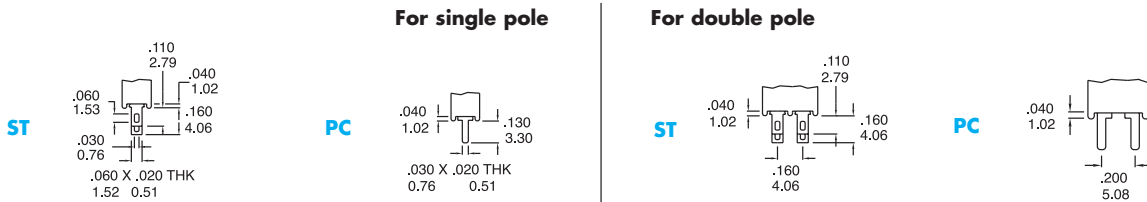

SERIES 2A

TERMINATIONS

**U2
SPDT**

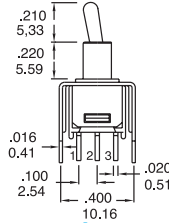
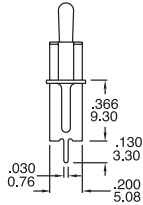

P.C. LAYOUT

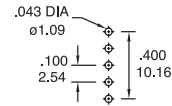

Part N° shown: **2A11-N2F2U2AE**

**U2
DPDT**

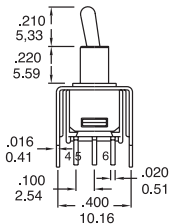
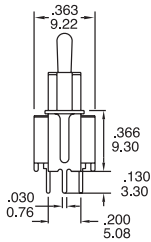

P.C. LAYOUT

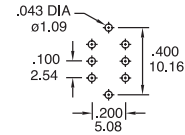

Part N° shown: **2A21-N2F2U2AE**

CONTACT MATERIALS

CONTACT RATINGS

- S** **Moving Contacts:** coin silver, silver plated
Terminals: brass, silver plated
Rating: 3 Amps @ 120 VAC or 28 VDC
 1.5 Amps @ 250 VAC
- A (std)** **Moving Contacts:** brass with gold plate over nickel plate
Terminals: brass with gold plate over nickel plate
Rating: 0.4 Volts/Amps max @ 20 VAC or DC max
- G** **Moving Contacts:** coin silver gold plated
Terminals: brass silver plated and gold plated
Note: G option used for either "high" (2 Amps @ 250 VAC) or "low" (0.4 Volts/Amps max) contact rating (one exclude the other)

PANEL CUT-OUT

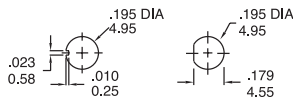
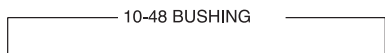

WITHOUT LOCKING RING

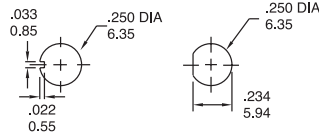
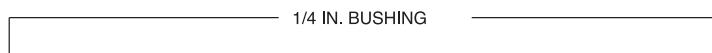

WITHOUT LOCKING RING

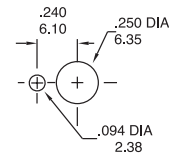

WITH STD. LOCKING RING



SERIES 2A

PACKAGING

Transparent Trays 15x21x4 cm



Qty per tray: (ST, PC Terminals)
 Series 2A1x 500 pcs
 2A2x 200 pcs

**MARKING
(on products)**

The switches are individually marked with the following information:

- Side 1** TRADE MARK
 SERIES AND MODEL
 DATE CODE
- Side 2** RATING
 CONTACTS

Note: Not all information may be available on some products.

**LABELLING
(on packaging)**

The label on each tray gives full information on the products contained.

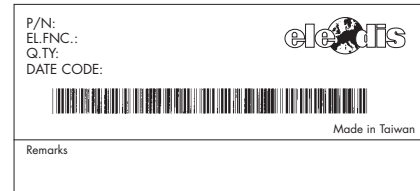

A Bar code indicating Model, Quantity, Date Code enables easy traceability.